

Newport Towne Square

100,000 SF Community Center

NWQ of Newport Road & Haun Road ~ Menifee, Ca



JOIN:



PROPERTY HIGHLIGHTS

- ◆ Premier upscale shopping center positioned at the heart of Menifee's regional shopping corridor
- ◆ Over 25,000 new housing units proposed within the Menifee trade area
- ◆ Shop space for lease from ±1,080 SF - Pad for built-to-suit
- ◆ Tremendous visibility and excellent signaled access with Newport Road ingress/egress
- ◆ Delivery Expected 2nd Quarter 2009

DEMOGRAPHICS

	1 Mile	3 Miles	5 Miles
Daytime Pop:	2,288	8,990	12,782
'06 Estimated Pop:	9,520	41,949	71,248
'06 Estimated Household Income	\$61,574	\$53,416	\$56,677

TRAFFIC COUNTS

Newport Road @ Haun Road	21,739 CPD
I-215 @ Newport Road	82,880 CPD

For further information,
please contact:

BRIAN BIELATOWICZ

951.445.4515

bbielatowicz@lee-associates.com

JAKE IRION

951.445.4519

jirion@lee-associates.com

TED RIVENBARK

951.445.4512

trivenbark@lee-associates.com



©25240 Hancock Avenue, Suite 100 - Murrieta, Ca. 92562 | P: 951.445.4500 F: 951.445.4527 | www.lee-associates.com
No warranty or representation has been made to accuracy of the foregoing information. Terms of sale or lease and availability are subject to change or withdrawal without notice.

Newport Towne Square Newport Towne Square

100,000 SF Community Center 100,000 SF Community Center

NWQ of Newport Road & Haun Road ~ Menifee, Ca

NWQ of Newport Road & Haun Road ~ Menifee, Ca

*Conceptual Site Plan

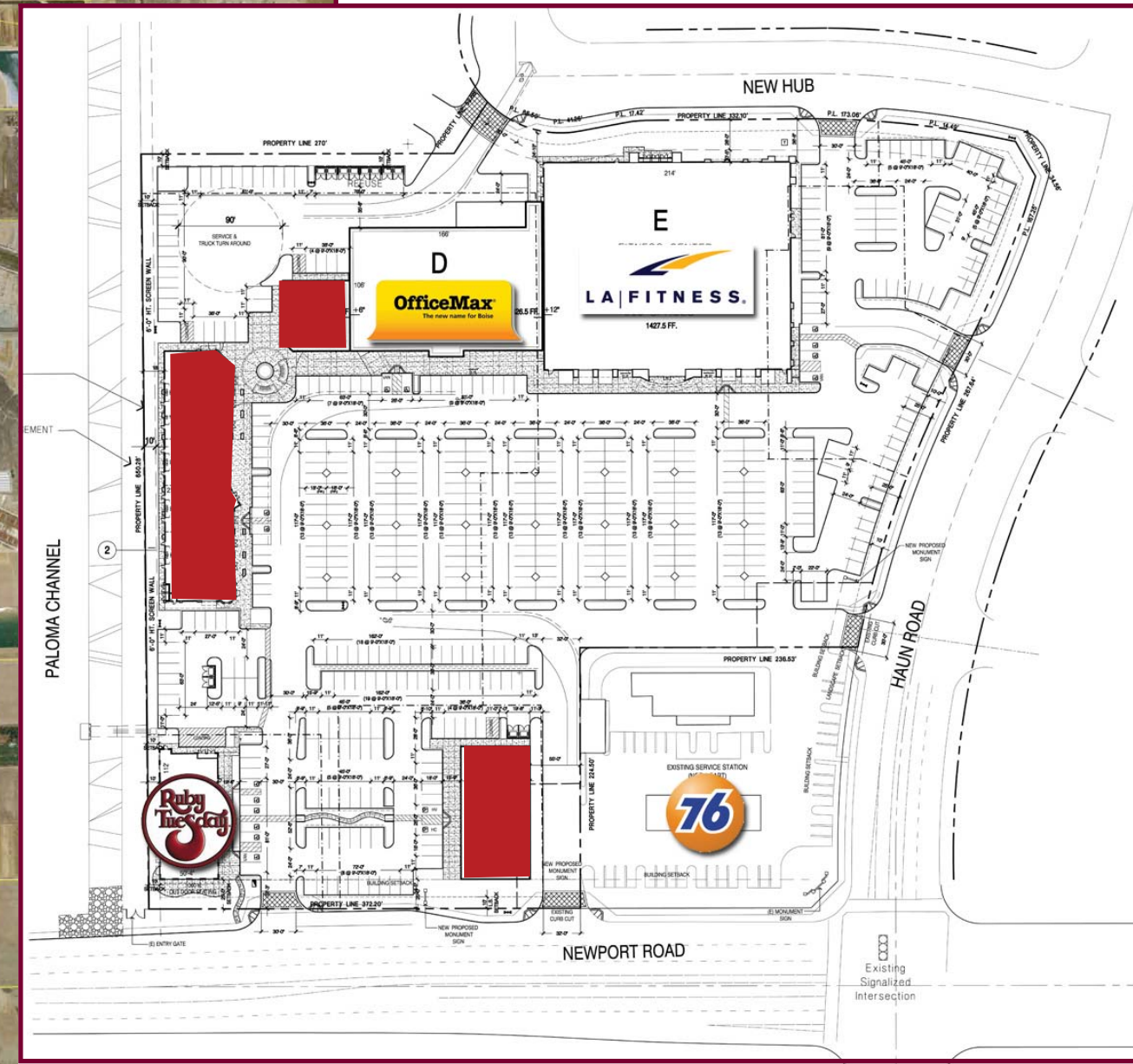

AVAILABLE
Divisible to 1,080 SF

For further information,
please contact:

BRIAN BIELATOWICZ 951.445.4515
bbielatowicz@lee-associates.com
JAKE IRION 951.445.4519
jirion@lee-associates.com
TED RIVENBARK 951.445.4512
trivenbark@lee-associates.com

Newport Towne Square

100,000 SF Community Center

NWQ of Newport Road & Haun Road ~ Menifee, Ca

Demographics	0.00 - 1.00 Miles		0.00 - 3.00 Miles		0.00 - 5.00 Miles	
	No.	%	No.	%	No.	%
Daytime Population	2,288		8,990		12,782	
Population						
2011 Projection	11,987		50,626		85,139	
2006 Estimate	9,520		41,949		71,248	
2000 Census	6,179		30,060		52,196	
Growth 2000-2006	54.09%		39.55%		36.50%	
Households						
2011 Projection	4,033		19,338		31,305	
2006 Estimate	3,277		16,547		26,895	
2000 Census	2,218		12,630		20,710	
Growth 2000-2006	47.74%		31.02%		29.86%	
2000 Estimated Population by Single Race Classification						
White Alone	7,977	83.79%	34,963	83.35%	57,871	81.22%
Black or African American Alone	186	1.95%	944	2.25%	1,328	1.86%
American Indian and Alaska Native Alone	80	0.84%	309	0.74%	573	0.80%
Asian Alone	298	3.13%	1,115	2.66%	1,706	2.39%
Native Hawaiian and Other Pacific Islander Alone	42	0.44%	93	0.22%	158	0.22%
Some Other Race Alone	609	6.40%	3,046	7.26%	7,034	9.87%
Two or More Races	327	3.43%	1,480	3.53%	2,579	3.62%
2006 Estimated Population Hispanic or Latino	9,520		41,949		71,247	
Hispanic or Latino	1,742	18.30%	8,408	20.04%	16,805	23.59%
Not Hispanic or Latino	7,777	81.69%	33,541	79.96%	54,443	76.41%
2006 Tenure of Occupied Housing Units	3,276		16,547		26,895	
Owner-Occupied	2,781	84.89%	13,513	81.66%	22,128	82.28%
Renter-Occupied	495	15.11%	3,034	18.34%	4,767	17.72%
2006 Average Household Size	2.88		2.52		2.63	
2006 Estimated Households by Household Income	3,276		16,547		26,895	
Less than \$15,000	276	8.42%	2,148	12.98%	3,289	12.23%
\$15,000 to \$24,999	290	8.85%	2,179	13.17%	3,474	12.92%
\$25,000 to \$34,999	288	8.79%	2,147	12.98%	3,361	12.50%
\$35,000 to \$49,999	670	20.45%	3,056	18.47%	4,652	17.30%
\$50,000 to \$74,999	844	25.76%	3,508	21.20%	5,668	21.07%
\$75,000 to \$99,999	468	14.29%	1,729	10.45%	3,003	11.17%
\$100,000 to \$149,999	334	10.20%	1,368	8.27%	2,562	9.53%
\$150,000 to \$249,999	98	2.99%	338	2.04%	717	2.67%
\$250,000 to \$499,999	7	0.21%	68	0.41%	150	0.56%
\$500,000 or more	1	0.03%	6	0.04%	19	0.07%
2006 Estimated Average Household Income	\$61,574		\$53,416		\$ 56,677	
2006 Estimated Median Household Income	\$53,040		\$43,609		\$ 45,716	

Source: Co Star

BRIAN BIELATOWICZ

951.445.4515

bbielatowicz@lee-associates.com

JAKE IRION

951.445.4519

jirion@lee-associates.com

TED RIVENBARK

951.445.4512

trivenbark@lee-associates.com

